



Sharp LM Series

Infrared Touch Displays

LM431 | LM551

www.sharpnecdisplays.eu

SHARP

The Multi-talented Display

From meetings to malls, engage your audience through collaborative touch!

A multi-purpose lineup of mid-size interactive displays, the Sharp LM Series commands feature-rich professional capabilities for small meeting spaces and interactive signage applications.

The 43-inch and 55-inch models enhance collaboration in huddle rooms across corporate and government offices, as well as in group learning and focus rooms in higher education. In retail settings, shopping malls, and museums, the LM Series supports engaging digital signage, wayfinding systems, and immersive experiences that promote interaction and learning.

Powerful out-of-the-box collaboration

Access key functions with a single click - launch apps, switch sources, annotate, and more, via the powerful Sharp home screen launcher. Instantly open pre-installed apps including:

- **Whiteboard:** For note taking and brainstorming.
- **Web Browser:** Access information in real-time.
- **File Manager:** Manage files from internal storage, USB memory device, or cloud storage (Google Drive, OneDrive).
- **EShare:** Wirelessly share content from your device to the display, and from the display to multiple devices, simultaneously.
- **MobiOffice:** Open and edit Office documents and PDF files without a PC.

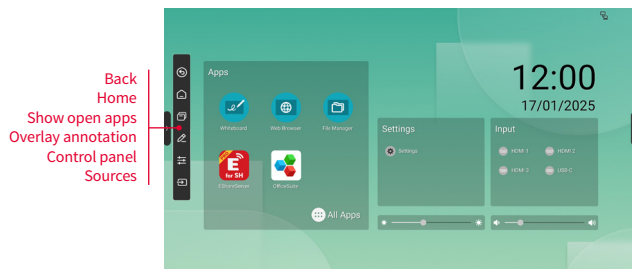
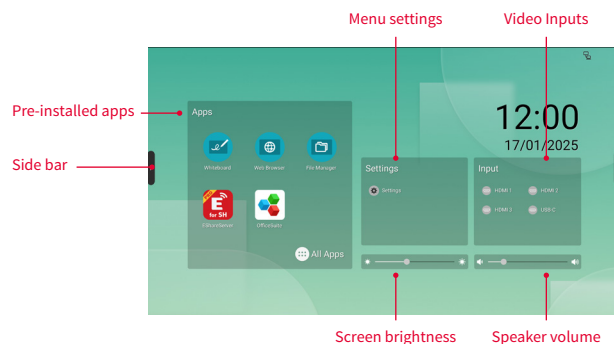

On-screen sidebar

The always-on sidebar provides quick access to tools, settings, and apps. For signage and wayfinding applications, the sidebar can be hidden to restrict access.

Control Panel

Accessible from the on-screen sidebar at any time and on any input, the control panel lets you access tools, settings, and apps without returning to the home screen.

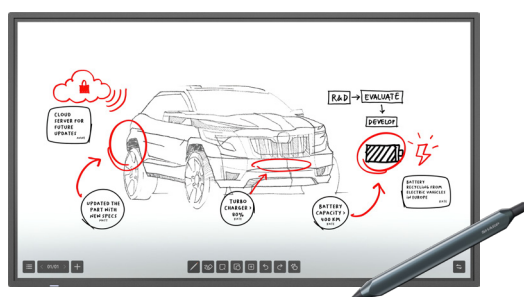
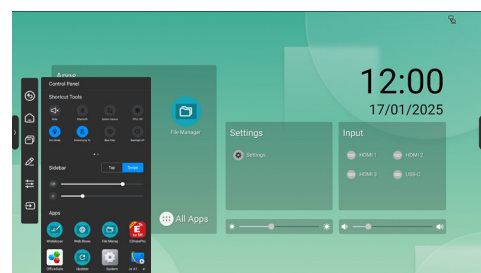

Pen-on-Paper writing

Enjoy the most intuitive and natural writing experiences thanks to zero-bonded glass. The ergonomic passive pen offers a choice of two pen tips for different usage, including support for Windows Ink.

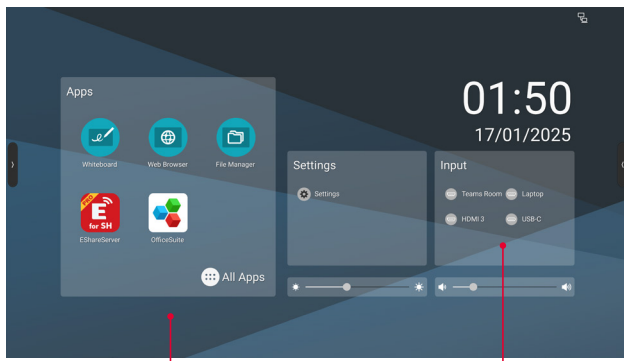

Change home screen wallpaper

Change names of input

Highly customisable

Every application has unique requirements, and the LM Series offers a range of customisation options to suit various preferences. With Google CTS certification, you can install your own apps on the System-on-Chip (SoC) and ensure compatibility with third-party Android apps. Alternatively, simply hide the Android SoC entirely if the built-in functionality is not needed.

Versatile installation

With multiple installation possibilities, the LM Series fits seamlessly into almost any setup, supporting landscape, portrait, or backward tilt up to 45 degrees. Its slim, 4-sided symmetrical bezel with no front-facing buttons or ports makes it ideal for modern office environments or for kiosks and touch signage.



Future-ready connectivity

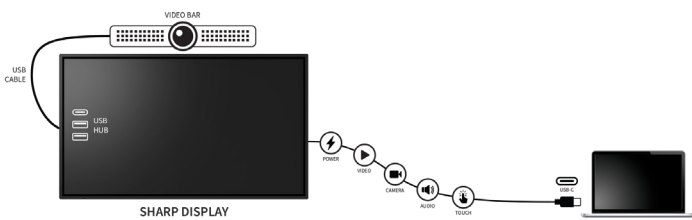

Securely connect your personal notebook via a single USB-C cable for versatile hybrid meetings. Use the built-in USB hub for quick set up with a camera or soundbar.

An HDMI output allows you to mirror content to a bigger canvas by connecting a projector or a dvLED wall.

Safe & Secure



Latest Android 14 SoC offers a secure operating system, which together with extra security features meets the highest IT security standards.



IEEE 802.1X

The LM Series supports IEEE802.1X authentication protocol for both Wi-Fi and LAN to ensure a secure connection to the internet.



Over-The-Air (OTA) software updates for the Android OS ensure availability of the latest features and system security.

	LM431	LM551
LCD	Panel Technology	VA / Direct LED
	Screen Size [inch]	43 / 108
	Brightness w/o Glass [cd/m2]	500
	Supported Orientation	Landscape / Portrait / Tilt (0-45°)
	Operating Hours	18/7
	Haze Level [%]	25
GLASS	Hardness [H]	9
	Bonding Technology	Zero Bonding
TOUCH	Touch Technology	Infrared
	Touch Points	20
	Input Method	Finger, Stylus, Gloves
	Packaged Pen	2x Passive Pens (2.6mm/6.8mm)
	Windows Ink	•
CONNECTIVITY	Video Input	1x USB Type-C (DisplayPort 1.4 Alt mode, HDCP, 65W PD, Touch signal, USB pass through); 3x HDMI (HDCP2.3, CEC, HDMI3-ARC)
	External Control	LAN (1000Mbit), 3.5mm Mini Jack IR Remote, RS-232C
	Data	1 x USB 2.0 (SoC + Wi-Fi Dongle); 1 x USB 3.0 (type-C); 3 x USB 3.0 (Downstream)
	Input Touch	1 x USB 3 (Type-B); 1x USB Type-C (shared with video input)
	Video Output	HDMI (HDCP2.3; loop through: HDMI, USB Type-C, Android SoC)
	Audio Output	1 x 3,5 mm jack
EMBEDDED COMPUTING	Slot-in Option	-
	Embedded SoC	Android 14
	System Memory	4GB RAM
	Internal Storage	32GB ROM
	Hide Android SoC	•
	App Side Loading (Android SoC)	•
POWER CONSUMPTION	Built-in Android Apps	File Manager, Web Browser, Whiteboard, Wireless Screen Sharing - EShare, Office & PDF Viewer - MobiOffice
	Power Consumption Eco (shipping) [W]	110
	Network Standby	2W
	ECO Standby	<0.5W
MECHANICAL	Speaker Rating	2x 10W
	Dimensions (W x H x D) [mm]	994 x 582 x 73
	Weight [kg]	21
	VESA Mounting [mm]	400 x 400
SENSORS	Bezel Width [mm]	15
	Temperature Sensor	Integrated
	Ambient Light Sensor	Optional via KTES1
	Human Sensor	Optional via KTES1
GREEN FEATURES	Energy Efficiency	ECO Mode; LED backlight; Scheduling
	Ecological Standards	Energy Star 8.0
CERTIFICATIONS	Barco ClickShare; Google CTS	
SHIPS WITH	2 x Passive Stylus; 2x AAA batteries; Blank Sticker; Bracket for Camera; Cable Clamps; Display; Power Cable; Remote Control; Setup Manual; USB cable; Wireless Adapter	
OPTIONAL ACCESSORIES	Eco Sensor (KTES1); Feet (ST-43M); Soundbar (PN-ZCMS1); Trolley (PD04 Tipster); USB-C cable (USB-C 5M; USB-C 7M); Wall mount (PDW S 32-65 L & P)	
SLOT-IN PC OPTIONS	OPS Slot-in PC Enterprise Pro; OPS Slot-in PC Enterprise Ultra	



Secure centralised control

Use the free NaViSet Administrator 2 software to centrally manage your entire estate of Sharp/NEC Displays and Windows computers. Reduce operating costs and optimise resources through task management, reporting, and on-demand control functionality with the convenience of an all-in-one remote support solution.



NaViSet
Administrator 2



Green features

Energy-saving presets and smart functionality such as auto-standby, scheduling and an optional ECO sensor with ambient light and presence detection help reduce energy use and extend the lifecycle. A metal back cover enables high recyclability (>97%) contributing to the circular economy, while eco-friendly packaging and optimised shipping cut carbon emissions.



This document is © Copyright 2025 Sharp NEC Display Solutions Europe GmbH. All rights are reserved in favour of their respective owners. The document, or parts thereof, should not be copied, adapted, redistributed, or otherwise used without the prior written permission of Sharp NEC Display Solutions Europe GmbH. This document is provided "as is" without warranty of any kind whatsoever, either express or implied. Errors and omissions are excepted. Sharp NEC Display Solutions Europe GmbH may make changes, revisions or improvements in, or discontinue the supply of any product described or referenced in this document at any time without notice.

Document Name: Sharp LM Series
Document Revision: Edition 1, 2025
Document Date: 08/25
Created by: FG

Sharp NEC Display Solutions Europe GmbH
Landshuter Allee 12-14,
80637 Munich, Germany

infomail.sndse@sharp.eu
Phone: +49 (0) 89 99 699-0

www.sharpnecdisplays.eu

SHARP